



PRINCIPESSA — MARINE PROJECTS UK



Builder: MARINE PROJECTS UK

Year Built: 1989

Model: Motor Yacht

Price: 55-000 € EUR Off the market

Location: Italy

LOA: 44' 8" (13.60m)

Beam: 10' 10" (3.30m)

Min Draft: 3' 8" (1.10m)

Cruise Speed: 18 Kts. (21 MPH)

Max Speed: 21 Kts. (24 MPH)

Our experienced yacht broker, Andrey Shestakov, will help you choose and buy a yacht that best suits your needs **PRINCIPESSA — MARINE PROJECTS UK** from our catalogue. Presently, at Atlantic Yacht and Ship Inc., we have a wide variety of yachts available on our sale's list. We also work in close contact with all the big yacht manufacturers from all over the world.

If you would like to buy a yacht **PRINCIPESSA — MARINE PROJECTS UK** or would like help answering any questions concerning purchasing, selling or chartering a yacht, please call **+1 954 274-4435**

TABLE OF CONTENTS

TABLE OF CONTENTS	2
SPECIFICATIONS	3
Overview	3
Basic Information	3
Dimensions	3
Speed, Capacities and Weight	3
Accommodations	3
Hull and Deck Information	3
Engine Information	4
DETAILED INFORMATION	5
Deck Equipment	5
Exclusions	5
Disclaimer	5
PHOTOS	6
CONTACTS	9
Contact details	9
Telephones	9
Office hours	9
Address	9

SPECIFICATIONS

Overview

Full Option - Very Motivated Seller – Make Offers

Basic Information

Category: Motor Yacht

Sub Category: Flybridge

Model Year: 1989

Year Built: 1989

Country: Italy

Fly Bridge: Yes

Dimensions

LOA: 44' 8" (13.60m)

Beam: 10' 10" (3.30m)

Min Draft: 3' 8" (1.10m)

Speed, Capacities and Weight

Cruise Speed: 18 Kts. (21 MPH)

Max Speed: 21 Kts. (24 MPH)

Water Capacity: 2 Gallons

Fuel Capacity: 1700 Gallons

Accommodations

Total Cabins: 2

Sleeps: 6

Total Heads: 2

Hull and Deck Information

Hull Material: Fiberglass

Hull Configuration: Modified V-Hull

Engine Information

Engines: 2

Manufacturer: Volvo Penta

Model: TAMD 61A

Engine Type: Inboard

Fuel Type: Diesel

DETAILED INFORMATION

Deck Equipment

Electronics Compass - Cockpit speakers - Plotter - Repeater(s) - CD player - Radio - Log-speedometer - Depthsounder VHF- GPS - Autopilot - TV set - Radar **Inside Equipment** Marine head - Air conditioning - Hot water - 3 Electric bilge pump - Battery charger - 2 Refrigerators - Heating - Oven - Manual bilge pump - Microwave oven **Electrical Equipment** Generator - 8 kW Mase - Shore power inlet - 12-24-220 V **Outside Equipment/Extras** Cockpit table - Cockpit cushions - Hydraulic gangway - Liferaft - Cockpit shower - Tender - Teak cockpit Radar reflector - Swimming ladder - Teak sidedecks - Cockpit cover

Exclusions

Owner's personal belongings. Owner's personal toys, including but not limited Jet-skis, Tenders, Sea Bobs, Fishing & Diving equipment.

Disclaimer

The Company offers the details of this vessel or yacht in good faith but cannot guarantee or warrant the accuracy of this information nor warrant the condition of the vessel. A buyer should instruct his representatives, agents, or his surveyors, to investigate such details as the buyer desires validated. This vessel or yacht is offered subject to prior sale, price change, or withdrawal without notice.

PHOTOS



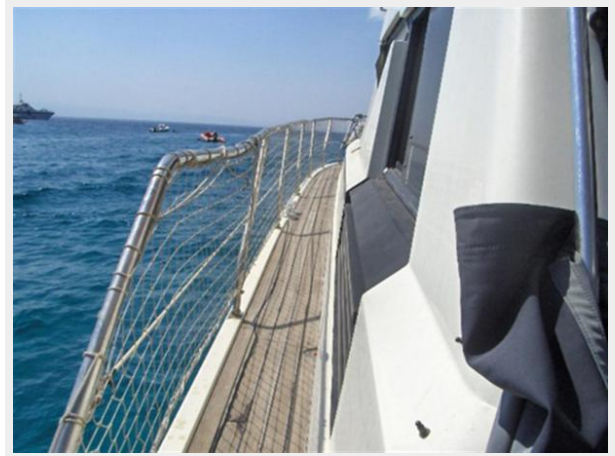

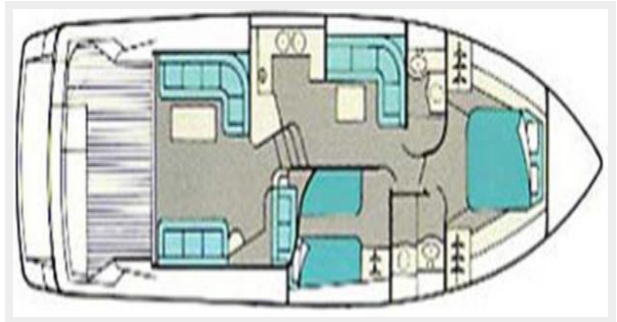

CONTACTS

Andrey Shestakov, leading yacht broker of the sales department of Atlantic Yacht and Ship Inc. Atlantic Yacht and Ship Inc., the official representative of the Miami/Fort Lauderdale FL headquarters.

Contact details

Email: info@atlanticyachtandship.ru

Web: www.atlanticyachtandship.ru/en/

Telephones

USA: +1 954 274-4435

RUS: +7 495 766-6268

Office hours

Monday – Saturday: **9:00 - 21:00** EDT

Sunday: **closed**

Address



Harbour Towne Marina, 850 NE 3rd St,
STE 213, Dania, FL 33004