



44' 2002 VOYAGE 440 — VOYAGE YACHTS



Builder: VOYAGE YACHTS

LOA: 44' 0" (13.41m)

Year Built: 2002

Beam: 25' 1" (7.65m)

Model: Catamaran

Max Draft: 3' 5" (1.04m)

Price: ~~\$199,000 USD~~ Off the market

Location: United States Virgin Islands

Our experienced yacht broker, Andrey Shestakov, will help you choose and buy a yacht that best suits your needs 44' 2002 Voyage 440 — VOYAGE YACHTS from our catalogue. Presently, at Atlantic Yacht and Ship Inc., we have a wide variety of yachts available on our sale's list. We also work in close contact with all the big yacht manufacturers from all over the world.

If you would like to buy a yacht 44' 2002 Voyage 440 — VOYAGE YACHTS or would like help answering any questions concerning purchasing, selling or chartering a yacht, please call +1 954 274-4435

TABLE OF CONTENTS

TABLE OF CONTENTS	2
SPECIFICATIONS	3
Basic Information	3
Dimensions	3
Speed, Capacities and Weight	3
Accommodations	3
Hull and Deck Information	3
Engine Information	4
DETAILED INFORMATION	5
Manufacturer Provided Description	5
Accommodations	5
PHOTOS	7
Manufacturer Provided Image: 440	7
Manufacturer Provided Image: 440	7
Manufacturer Provided Image: 440	7
Manufacturer Provided Image: 440	7
Manufacturer Provided Image: 440	8
Manufacturer Provided Image: 440	8
Manufacturer Provided Image: 440	8
CONTACTS	9
Contact details	9
Telephones	9
Office hours	9
Address	9

SPECIFICATIONS

Basic Information

Year Built: 2002	Category: Catamaran
Model Year: 2002	Year Built: 2002
Country: United States Virgin Islands	Fly Bridge: No
Cockpit: No	Helipad: No

Dimensions

LOA: 44' 0" (13.41m)	LWL: 40' 6" (12.34m)
Beam: 25' 1" (7.65m)	Max Draft: 3' 5" (1.04m)
Clearance: 62' 0" (18.90m)	

Speed, Capacities and Weight

Displacement: 20240 Pounds	Water Capacity: 150 Gallons
Fuel Capacity: 106 Gallons	

Accommodations

Total Cabins: 4	Total Berths: 4
Total Heads: 4	Captain Cabin: False

Hull and Deck Information

Hull Material: Fiberglass

Engine Information

Engines: 2

Manufacturer: None

Engine Type: Inboard

Fuel Type: Diesel

DETAILED INFORMATION

Manufacturer Provided Description

The Voyage 440 is a performance, luxury, bluewater cruising catamaran. The spacious galley up combines with the saloon and cockpit to form an exceptional entertainment area. All cabins have queen-size beds. The layout options offer either the Owners version with three queen-size cabins, and a choice of two or three head / showers; or the Charter version with four queen-size cabins, and four head / showers. The deck has been designed for safety and shorthanded sailing with all controls led aft to the coachroof winches. The 440 also features a generous performance sail plan. The ample deck and trampoline area allow for comfortable outdoor activities, and the large cockpit is shaded by a bimini with hardtop walkway aft. The traveler arch features a step-through to the dive platform.

Accommodations

HULL DECK AND BULKHEADS • Antifouling over epoxy based osmosis barrier • Closed cell PVC foam core, vacuum bonded for stiffness, strength and minimal weight • Forward water tight compartments with horizontal bulkheads • Hand laid-up GRP construction using multi layers of Quadraxial glass roving, isophthalic and orthophthalic polyester resin and other highest grade material • Low aspect reinforced keels • Marine ply and balsa core on critical structure bulkheads for added strength and stiffness • Reinforced fitting areas for cleats and chain plates • Skeg supported rudders

DECK FITTINGS: STAINLESS STEEL, Grade 316 • Bow pulpits with teak seats • Double guard wires • Grab rails on coach roof • Pushpits on stern with brackets for life ring buoys and overboard lights • Stanchions and stanchion bases • Swim ladder Starboard • Water stays attachment points for bow sprit • Gates in guard wires • Swim ladder Port

DECK EQUIPMENT • 1 x Electric windlass: LOFRANS • 2 x Primary winches on coach roof: ANDERSEN 46ST • 2 x Secondary winches in cockpit: ANDERSEN 46ST • 8 x Aluminium mooring cleats • Teak walkway between trampolines • Tracks, cars, jammers and blocks • Webbing trampolines (one season) • Propane BBQ (PARKER Grill) on Dive Platform • Snorkeling Equipment

PLUMBING: • 2 x Black water systems, holding tanks • 2 x Manual bilge pumps • 2 x Water heater 22 litre • 4 x Automatic electric bilge pumps • Pressurized hot and cold deck shower (starboard) • Self draining cockpit

HATCHES AND WINDOWS: • 11 x LEWMAR hatches • 2 x GRP locker lids: foredeck • 7 x GRP locker lids: cockpit • 8 x LEWMAR port lights • 8 x Reflective laminated safety glass windows • Anodised aluminium framed sliding door with safety glass and fixed opening positions • Ventilation/Escape hatch with teak grid in galley • Dive equipment hatch and locker in aft coaming

SAFETY EQUIPMENT: • Basic safety equipment including: flares, life jackets, first aid kit and life rings

RIGGING: • 7/8th fractional rig • Anchor chain lead internally through compression post • Anodised Aluminium mast, boom, cross beam and double compression post • Attachment point for bow sprit • Color coded sheets and control lines • Double purchase main halyard • Flag halyards, Port and Starboard • Mast

supported by triple spreaders, intermediate and cap shrouds, forestay and inner forestay • Reefing lines x 2 and luff pendants x 2 • Telescopic boom derrick for hauling dinghy on to dive platform SAILS: • Fully battened main with large roach, 2 reef points, 10.3 oz high modulus, cross cut Dacron (new) • Furling genoa with foam luff and UV cover, 7.3 oz high modulus cross cut Dacron • HARKEN battcar system for mainsail • Mainsail stowage pack with lazy jacks • PROFURL genoa roller furler COCKPIT/AFT DECK: • 7 x Storage lockers • Dingy stowage supports and BBQ mounting point • Double helmsman's seat • GRP Cockpit table • Sheet pouches x 2, Utility pouch x 1 • Steering console including • Instrument console • Stainless steel steering wheel • Teak dive platform/aft deck • Traveller arch • Cockpit Cushions • Cockpit table - White GRP – Removable ACCOMMODATION: MAIN SALOON • Izit Leather (new) upholstered settee • Coffee table • CORIAN type work surfaces • Modules in moulded GRP • Standing height throughout 1.9m • Storage in seating modules GALLEY: • 4 x Burner propane hob and propane oven • CORIAN type work surfaces with stainless steel rails and fiddles • Facility for microwave oven • Front opening refrigerator - 12V air cooled ADLER/BARBOUR • Large recessed drip tray • Modules in moulded GRP • Pressurized hot and cold water • Stainless steel sink • Stainless steel waste chute with cover • Top opening freezer, 12V air cooled ADLER/BARBOUR • Galley Appointments FORWARD AND AFT CABINS: • Access to bow storage • Cabin and reading lights • Cabin lights & reading lights • Cave lockers • Hanging and storage cupboards • Laundry locker with upholstered cover • Modules in moulded GRP • Queen size bunk with split mattresses • Stainless steel towel rail • Cabin Appointments BOW CABINS • Cabin Appointments • Cabin Light • Fan • Hatch • Single V-Berth HEAD COMPARTMENTS: • Integrated shower grate and sump • Manual marine toilet • Mirror • Modules in moulded GRP • Stainless steel towel rail • Vanity cabinet • Wash basin and shower with hot and cold water • 4 x Heads, 2 x Port, 2 x Stbd NAVIGATION CENTRE: • Access panels to electrical installation and systems • Instrument console • Navigation seat • Chart table with recessed chart stowage INSTRUMENTATION: • Compass • ICOM M-402 VHF Radio with antenna on mast • RAYMARINE ST60 Tridata & Wind COMFORT AND LIFESTYLE: • Dimmers, Courtesy Lights, Boom light, 12V outlet • Sound system, 12V Radio/CD and 4 Marine speakers in saloon/cockpit ELECTRICS: • 2 x 160A AMPLE alternators with SMART multi stage regulators • 2 x Engine start batteries (12V) @ 65 AH • AC shore cable socket • Battery isolator switches • Ceiling lights • Circuit breaker panel • Cockpit lights • Deck light • Interior AC outlets: 3 in saloon, 1 in each cabin • Lazarette and engine compartment lights • LINK 2000 battery management system • Mast top and lower navigation lights • Ships load battery banks (12V) gel - 300AH x 2 (600AH) • HEART 25 Inverter/Charger 12V to 110V • Shore power cable 30A ENGINE EQUIPMENT: • 2 x Instrument panels with engine hour meters • 2 x 55A alternators • High pressure fuel lines • Sound insulation • 2 x 40Hp fresh water cooled YANMAR diesel engines with saildrives and fixed propellers MOORING GEAR AND GROUND TACKLE: • 25kg DELTA anchor (new 08) with tipper • 50m galvanized chain (new 08) and 50m nylon anchor rode • Anchor bridle with thimbles for anchoring • Dock lines and fenders • Two anchor rollers, one with tipper • FORTRESS anchor F23 INFLATABLE • 12ft APEX RIB tender (new 08) with 15Hp outboard engine

PHOTOS

Manufacturer Provided Image: 440



Manufacturer Provided Image: 440



Manufacturer Provided Image: 440



Manufacturer Provided Image: 440



Manufacturer Provided Image: 440



Manufacturer Provided Image: 440

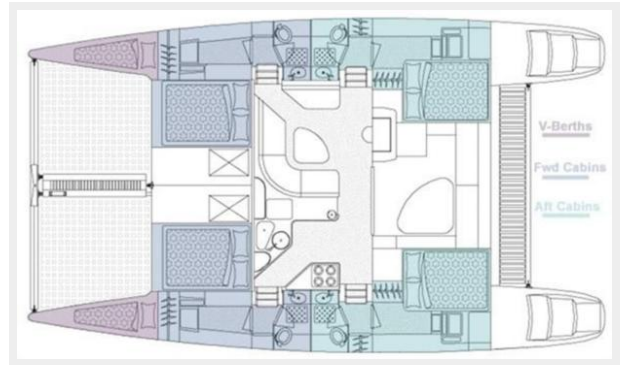

Manufacturer Provided Image: 440



CONTACTS

Andrey Shestakov, leading yacht broker of the sales department of Atlantic Yacht and Ship Inc. Atlantic Yacht and Ship Inc., the official representative of the Miami/Fort Lauderdale FL headquarters.

Contact details

Email: info@atlanticyachtandship.ru

Web: www.atlanticyachtandship.ru/en/

Telephones

USA: +1 954 274-4435

RUS: +7 495 766-6268

Office hours

Monday – Saturday: **9:00 - 21:00** EDT

Sunday: **closed**

Address

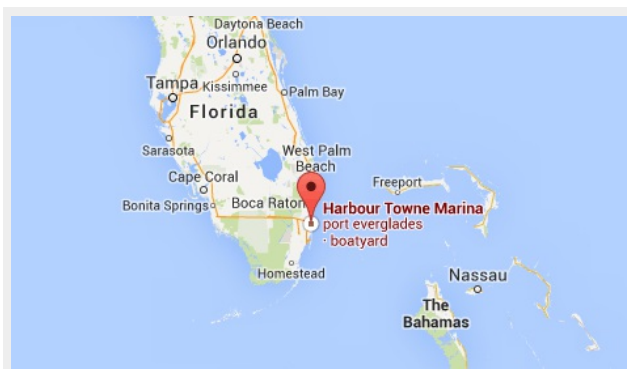

Harbour Towne Marina, 850 NE 3rd St,
STE 213, Dania, FL 33004