



CARA — NAUTOR'S SWAN



Builder: NAUTOR'S SWAN

Year Built: 1982

Model: Cruising/Racing Sailboat

Price: ~~\$309,000 USD~~ Off the market

Location: United States

LOA: 51' 3" (15.62m)

Beam: 14' 9" (4.50m)

Min Draft: 5' 10" (1.78m)

Max Draft: 9' 10" (3.00m)

Our experienced yacht broker, Andrey Shestakov, will help you choose and buy a yacht that best suits your needs **Cara — NAUTOR'S SWAN** from our catalogue. Presently, at Atlantic Yacht and Ship Inc., we have a wide variety of yachts available on our sale's list. We also work in close contact with all the big yacht manufacturers from all over the world.

If you would like to buy a yacht **Cara — NAUTOR'S SWAN** or would like help answering any questions concerning purchasing, selling or chartering a yacht, please call **+1 954 274-4435**

TABLE OF CONTENTS

TABLE OF CONTENTS	2
SPECIFICATIONS	4
Basic Information	4
Dimensions	4
Speed, Capacities and Weight	4
Accommodations	4
Hull and Deck Information	4
Engine Information	5
DETAILED INFORMATION	6
Accommodation	6
Hull	6
Misc. Equipment	6
Deck Equipment	6
Galley & Plumbing	7
Sails and Rigging	7
Electronics	7
Exclusions	8
Disclaimer	8
PHOTOS	9
Dinette	9
Main salon	9
Galley	9
Guest Cabin	11
CONTACTS	12
Contact details	12
Telephones	12
Office hours	12

Address

12

SPECIFICATIONS

Basic Information

Category: Cruising/Racing Sailboat

Model Year: 1982

Year Built: 1982

Country: United States

Coast Guard #: 916594

Cockpit: Yes

Dimensions

LOA: 51' 3" (15.62m)

LWL: 42' 4" (12.90m)

Beam: 14' 9" (4.50m)

Min Draft: 5' 10" (1.78m)

Max Draft: 9' 10" (3.00m)

Speed, Capacities and Weight

Displacement: 41900 Pounds

Water Capacity: 184 Gallons

Fuel Capacity: 68 Gallons

Accommodations

Sleeps: 8

Total Heads: 2

Hull and Deck Information

Hull Material: Fiberglass

Deck Material: Teak

Hull Color: White

Hull Finish: Stainless Steel

Hull Designer: German Frers

Engine Information

Engines: 1

Manufacturer: Perkins

Model: 42.236M

Engine Type: Inboard

Fuel Type: Diesel

DETAILED INFORMATION

Accommodation

Starting in the forepeak, there is a sail, anchor, chain & misc. storage with pipe berths. Moving aft on port side is a single berth for extra crew. Opposite is guest cabin with upper and lower berths, and guest head with sink, hand held shower unit, vanity and Blake manual toilet. Entering the main salon, a large U-shaped dining area to starboard with storage and bookshelves outboard with custom folding table in center of seating arrangement. Opposite is a single settee with pilot berth outboard and storage beneath. Wine storage rack under the table, and a liquor drawer/locker on port side forward. In the port aft corner of the salon is the galley with double stainless steel sink, fresh and salt water foot pumps, top loading & front opening ice boxes with Adler Barbour refrigeration. Dickson 3 burner stove with oven/grill and exhaust fan. There are numerous storage compartments/lockers/drawers. On starboard side is the navigation station with all electronics conveniently mounted for easy use. A lift top chart locker is provided and numerous small storage compartments and drawers. Moving aft, engine access is below companionway and from the aft cabin. Entering aft cabin, a large double berth is located port side, single on starboard. An enclosed head is located in the port side. Aft cabin entrance hatch from deck, which was enlarged for easier access. The floorboards and interior woodwork are in excellent condition, extremely well cared for by her owners.- Custom teak mast cover in salon- Extra reading lights throughout- Teak trim around overhead lights- Folding teak shelf port side salon- Liquor locker port side main salon- Cabin curtains- Hella fans throughout- Covers for ultrasuede in salon- Antique clinometer in owner's cabin- Custom drawers in aft cabin

Hull

Regelled coach house and stripes; double black stripes (2001)Regelled double black boot stripes (2001)Gold leafed cove stripes (2001)Black bottom (2001)

Misc. Equipment

- Zodiac 6 man life raft in container (2000)- Life preservers- Firdel radar reflector- Fire extinguishers- Bosun's chair- Horseshoe ring & holder w/strobe- Safety harnesses- MOB module- Auto. Halon 1301 system in engine compartment- Shaft line cutter- Searchlight- Extensive spare parts inventory- Spare engine heat exchanger

Deck Equipment

Lofrans windlass rebuilt 1997 (electric) with remote control; emergency tiller; single & double winch handles; stainless steel wheel with elkhide cover; added new stainless steel cowl vents (5) with varnished teak caps on deck housing in 2001; 4 opening ports; 4 opening Goiot deck hatches; custom made screens for all ports & hatches; access hatch between cockpit & aft cabin enlarged for easier access; teak decks glued & screwed.- CQR, 65 ;b. on bow roller- 200' 3/8" anchor chain- 60' 1/2" chain with 200' rode- Fenders- Deck washdown- Deck covers- Wind scoop for forward hatch- Two dodgers- Dock lines- 40 lb folding fisherman's anchor- 45 lb Fortress anchor- Chain snubber- Teak flag pole- Two varnished teak cockpit tables - one for center cockpit, 1 attached to steering column aft cockpit- Cockpit cushions- New light blue mainsail cover (2001)- Wheel cover- Table & compass covers- Small lunch awning- Full length awnings for the tropics- Electric up/down windlass w/remote WINCHES: 1 x L55ST electric for main & jib 1 x L55 manual ST2 x L65 manual ST2 x L48 manual ST3 x L44 manual ST1 x L18 manual ST1 x L8 manual 1 centerboard electric winch, operating from cockpit with override

Galley & Plumbing

Heads: 2 heads, each with Senior Blake Toilets, hand held shower; forward head has holding tank with diverter valve; exhaust fans; opening ports. Galley:- 4 burner Dickinson stove w/oven- Double stainless steel sinks with drain rack- Hot & cold pressure water- Fresh water tap has sep. filter- Aux. foot pumps for pressure system in heads & galley- One electric bilge pump- Two manual gusher bilge pumps- Solenoid stove/propane shut off- 110 volt refrigeration w/cold plate- Engine driven refrigeration w/cold plate- Galley exhaust fan- Complete set of cutlery- Complete set of Villeroy & Boch dishes- Engine battery new 2000 - Service batteries 1996- Espar heading system- 12 gallon hot water heater/dual element

Sails and Rigging

Double spreader, oval section Nautor aluminum rig; welded masthead; two spinnaker cranes; four halyard sheaves; tapered spreaders; Navtec rod rigging. Main with Lazy Jacks #3 genoa #2 genoa MPS in sock Staysail Staysail stay with release lever Hood sea furl jib stay & foil Approximately 7 other sails at yard storage locker Falmouth Marine Navtec hydraulic backstay (new 2003) Double genoa sheet tracks Genoa sheets, spinnaker sheets Running backstays Slab reefing Navtec hydraulic boom vang (rebuilt 2003) 2 spinnaker poles Babystay

Electronics

- New Furuno radar (2004) mast mount- New Nortstar GPS (2001) 3 chips - Buzzards Bay, MA to full coverage Penobscot Bay, ME- Radar, autopilot, Northstar GPS are "linked" systems.- New radio telephone (2001)- Robertson autopilot (rebuilt platform 2001)- Hornet system (wind speed, wind point, speed, depth)- Added repeaters companionway bulkhead- Repeaters aft cockpit-

Stereo and 10 disc CD- Speakers in main cabin & cockpit- EPIRB- Fuel gauge- Battery charger- Large inverter (24 v to 110 v)

Exclusions

Owner's personal belongings. Owner's personal toys, including but not limited Jet-skis, Tenders, Sea Bobs, Fishing & Diving equipment.

Disclaimer

The Company offers the details of this vessel or yacht in good faith but cannot guarantee or warrant the accuracy of this information nor warrant the condition of the vessel. A buyer should instruct his representatives, agents, or his surveyors, to investigate such details as the buyer desires validated. This vessel or yacht is offered subject to prior sale, price change, or withdrawal without notice.

PHOTOS

Dinette



Main salon



Galley





Guest Cabin

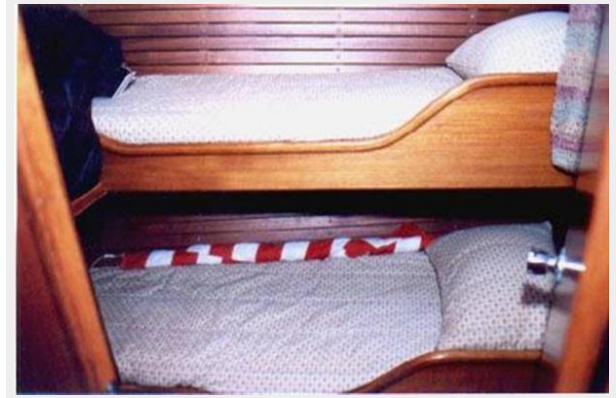
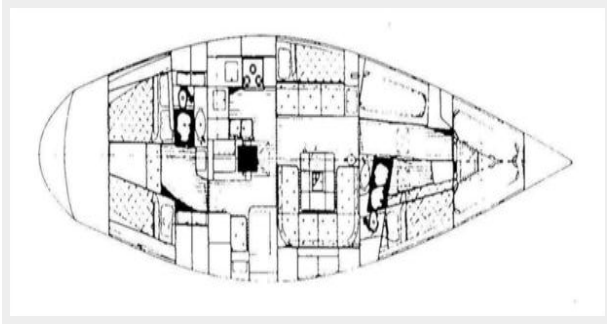

CONTACTS

Andrey Shestakov, leading yacht broker of the sales department of Atlantic Yacht and Ship Inc. Atlantic Yacht and Ship Inc., the official representative of the Miami/Fort Lauderdale FL headquarters.

Contact details

Email: info@atlanticyachtandship.ru

Web: www.atlanticyachtandship.ru/en/

Telephones

USA: +1 954 274-4435

RUS: +7 495 766-6268

Office hours

Monday – Saturday: **9:00 - 21:00** EDT

Sunday: **closed**

Address

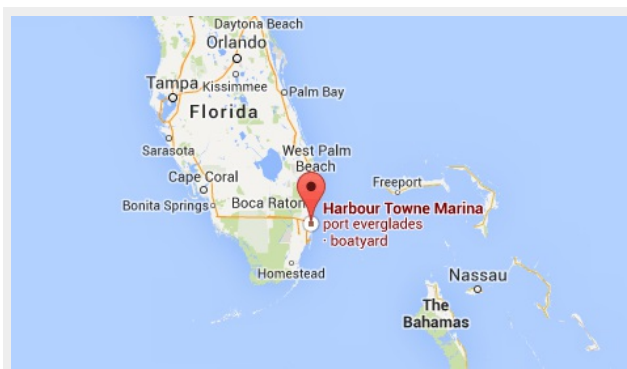

Harbour Towne Marina, 850 NE 3rd St,
STE 213, Dania, FL 33004